

# Hummingbird Delight

Designed by Christine Woods of Matrix Gardens



Rejoice in the beauty of the gorgeous Hummingbird Delight garden. A stream of bright pinks, rich purples, reds, and yellows bring together a show-stopping display of color. Fill your landscape with native classics and rare varieties such as the kaleidoscopic Rondo Penstemon and the fragrant Coronado® Hyssop. Whether it's your local hummingbird or next-door neighbor, all visitors will enjoy the delights of this garden.

- Full sun exposure (minimum of 6 hrs of direct sun per day)
- Planting maps cover 60 sq. ft.
- Blooms spring to fall
- Low water needs
- Hardiness maximum of 5,500 ft.

## Individual Plant Information

### BLUE GRAMA GRASS - *Bouteloua gracilis*

QTY. 1



A cold hardy, warm season dense tuft-forming grass. This is the Colorado state grass, so it's native, and has interesting horizontal blossom clusters that look like eyelashes.

- Mature height 1-2' Mature spread 1-2'
- Full sun
- Very low water needs
- Blooms summer to fall
- Attracts birds, butterflies
- Resists deer, rabbits

**CARE:** This native grass tolerates many soil types and is semi-evergreen. A great winter interest plant so don't cut it down until spring!

### CHOCOLATE FLOWER - *Berlandiera lyrata*

QTY. 1



Native to the southwestern US, this bright yellow, daisy-like flower blooms at night and emits a distinct milk chocolate fragrance in the early morning hours.

- Mature height 1-2' Mature spread 12-18"
- Full sun
- Low water needs
- Blooms summer to fall
- Attracts bees, birds, butterflies
- Resists deer

**CARE:** This hardy and easy-to-care-for perennial is adaptable to a wide spectrum of conditions. However, it tends to prefer soil that is not amended and thrives best in full sun locations but will tolerate light shade. Once established, it requires very little water. If overwatered, it will become extra leggy. This plant can sprawl a bit.

### CORONADO® HYSSOP - *Agastache aurantiaca* 'Coronado®'

QTY. 2



Native to the southwestern US, this hyssop has silvery green leaves on slim, branched stems with large numbers of curved, pale orange flowers from mid-summer until the first frost.

- Mature height 15-18" Mature spread 12-15"
- Full sun to part shade
- Low water needs
- Blooms midsummer to fall
- Attracts hummingbirds
- Resists deer, rabbits

**CARE:** Water regularly for the first season to establish the root system. Make sure the soil is well drained, as hyssops do not tolerate soil that is constantly wet. After it is established, it is very drought tolerant.

FASSEN'S CATMINT - *Nepeta x faassenii*

QTY. 1



Known for its long bloom season, it has abundant lavender-colored and fragrant blooms produced at the stem tips from spring through late summer.



Mature height 18-24"  
Mature spread 18-24"



Full sun



Low water needs



Blooms spring to late summer



Attracts bees, butterflies, hummingbirds



Resists deer, rabbits



**CARE:** Catmint is an easy-to-care-for plant that can self-seed readily if not cut back throughout the growing season. Does not need much additional watering once established.

KNAUTIA - *Knautia macedonica*

QTY. 1



Knautia is a tall and clump-forming perennial with deep red pincushion flowers atop slender leaves. It makes an excellent cut or dried flower.



Mature height 18-24"  
Mature spread 18-24"



Full sun



Low water needs



Blooms summer



Attracts butterflies



**CARE:** Knautia is a fast-growing plant that requires little maintenance. This plant prefers dry and more alkaline soils, although it is tolerant of most soil types. The plant can be short lived, but tends to self-seed. Plant may droop in the summer heat.

MISSOURI EVENING PRIMROSE - *Oenothera macrocarpa*

QTY. 1



It has large, almost square, lemon-yellow flowers. Although the flowers are only open for one evening, the plant will bloom again and again.



Mature height 1-2'  
Mature spread 18-24"



Full sun



Low water needs



Blooms summer



Attracts bees, butterflies



Resists deer, rabbits



**CARE:** The Missouri Evening Primrose fares well in hot, dry areas with well-drained soil, and once established, it will become drought-tolerant. Prevent complete soil dryness, and maintain a mulch layer.

ANGELINA STONECROP - *Sedum rupestre* 'Angelina'

QTY. 1



Trailing mats of succulent, chartreuse, needle-like foliage form a low groundcover. The tips of the foliage often have a dark amber color.



Mature height 4-6"  
Mature spread 12-18"



Full sun



Low water needs



Blooms summer



Attracts butterflies



Resists deer, rabbits



**CARE:** This stonecrop needs very little care and propagates by seed. Be sure not to overwater!

PINELEAF PENSTEMON - *Penstemon pinifolius*

QTY. 1

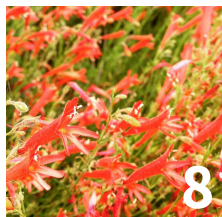

This low, creeping penstemon features tubular, scarlet-orange flowers with yellow throats. The prolific blooms rest atop soft, green needle-like foliage, covering the plant throughout the mid-summer months.



Mature height 6-8"  
Mature spread 12-15"



Full sun



Low water needs



Blooms midsummer



Attracts hummingbirds



Resists deer, rabbits



**CARE:** Penstemon varieties prefer not to be overcrowded and prefer maximum heat and sun exposure. Avoid enriching the soil around these finicky plants — it will shorten their lifespan. This semi-evergreen can be slow to establish, so be sure to weed around it regularly to improve establishment.

RED CARPET STONECROP - *Sedum spurium* 'Red Carpet'

QTY. 1

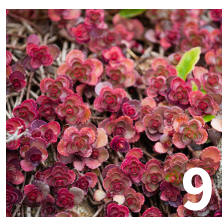

Deep reddish-green, wedge-shaped leaves cover trailing stems to form a low-growing flower carpet with clusters of rosy red blooms. Red color remains in fall and winter providing off-season interest.



Mature height 2-4"  
Mature spread 12-18"



Full sun



Low water needs



Blooms midsummer



Attracts butterflies



Resists deer, rabbits



**CARE:** Very low-maintenance plant with a quick growth rate. Be sure not to overwater!



A succession of bright rose flowers above narrow, dark green leaves that form an attractive mound. Attract hummingbirds and a variety of bees with this easy-care perennial.

Mature height 12-15"  
Mature spread 8-12"

Full sun

Low water needs

Blooms spring to summer

Attracts bees, birds, butterflies

Resists deer, rabbits

**CARE:** Snap spent flower stalks to prolong blooming on this easy-to-care-for perennial.



With a range of red, pink, purple, blue, and violet tubular flowers, the Rondo Penstemon provides a variety of showy blooms throughout the summer.

Mature height 12-18"  
Mature spread 6-12"

Full sun

Low water needs

Blooms summer

Attracts bees, birds, butterflies

**CARE:** Snap spent flower stalks to prolong blooming on this easy-to-care-for perennial.

# Plant Maintenance by Season

## MAINTENANCE TASKS

## PLANT

### SPRING (AFTER FIRST GROWING SEASON)

Cut back old growth to 6 inches before new growth begins to show.

Blue Grama Grass, Chocolate Flower, Coronado Hyssop, Fassen's Catmint, Missouri Evening Primrose, Pineleaf Penstemon, Red Rocks Penstemon, Rondo Penstemon

Divide mature plants in early spring every 3 years, as needed.

Pineleaf Penstemon

"Comb out" or remove dead foliage.

Angelina Stonecrop, Red Carpet Stonecrop

### SUMMER

Water sparingly once established.

Chocolate Flower, Coronado Hyssop, Fassen's Catmint, Red Carpet Stonecrop

Deadhead spent flowers to encourage new blooms and/or minimize self-seeding.

Chocolate Flower, Fassen's Catmint, Knautia, Missouri Evening Primrose, Red Rocks Penstemon, Rondo Penstemon

### FALL

Leave last round of blooms to self-seed and/or to provide food for birds.

Chocolate Flower, Red Rocks Penstemon, Rondo Penstemon

Deadhead to prevent self-seeding and spreading.

Fassen's Catmint, Missouri Evening Primrose

Do not prune or cut back. Plant susceptible to winter damage if pruned.

Coronado Hyssop

# Plant-by-Number Design Suggestions

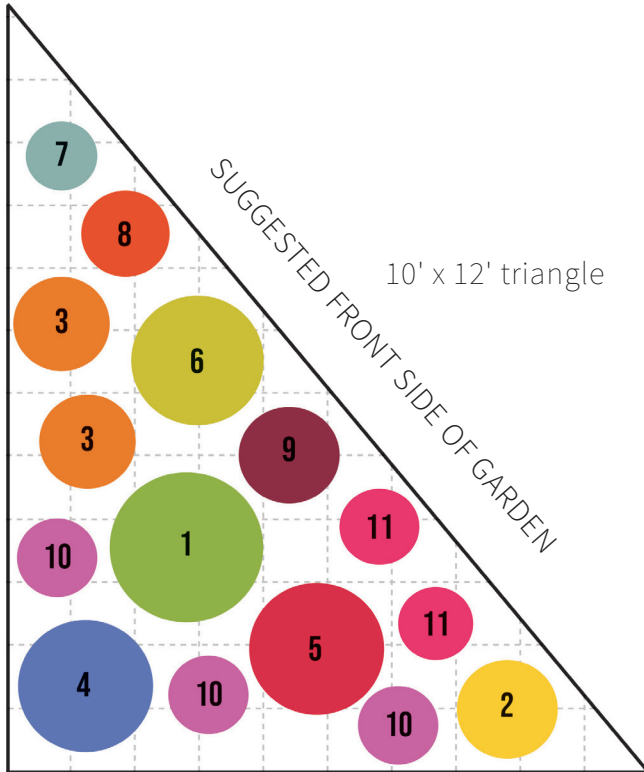

## Key

1. Blue Grama Grass (Qty. 1)
2. Chocolate Flower (Qty. 1)
3. Coronado® Hyssop (Qty. 2)
4. Fassen's Catmint (Qty. 1)
5. Knautia (Qty. 1)
6. Missouri Evening Primrose (Qty. 1)
7. Native Stonecrop (Qty. 1)
8. Pineleaf Penstemon (Qty. 1)
9. Red Carpet Stonecrop (Qty. 1)
10. Red Rocks Penstemon (Qty. 3)
11. Rondo Penstemon (Qty. 2)

1 box = 1 square foot

