

Shades of Summer

Designed by Kenton Seth of Paintbrush Gardens



Bring in those warm tones of summer to the shaded areas of your yard with the Shades of Summer garden! This garden boasts boldly colored, xeric perennials that appreciate a break from the hot summer sun. Ranging in color from soft pinks to deep reds to blues and golden yellow, these brilliant show-stopping plants are not to be missed. Relax in the welcomed summer shade and enjoy this eye-catching waterwise garden.

- Part shade exposure (requires only 4 hrs of direct or indirect sun per day)
- Planting maps cover 100 sq. ft.
- Blooms early spring to fall
- Low to medium water needs
- Hardiness maximum of 6,500 ft.

Individual Plant Information

BIOKOVO CRANESBILL GERANIUM - *Geranium x cantabrigiense* 'Biokovo'

QTY. 4



A great evergreen groundcover with its bright pink flowers above a compact spreading clump of rounded, light green leaves that turn wine-red in the fall.

- Mature height 6-12"
Mature spread 12-18"
- Sun to part shade
- Medium water needs
- Blooms late spring to midsummer
- Attracts butterflies
- Resists deer, rabbits

CARE: Although this Geranium can tolerate drought once established, it appreciates moist, well-drained soils.

KOREAN FEATHER REED GRASS - *Calamagrostis brachytricha*

QTY. 4



Clump-forming grass with stiff, upright foliage. It is accented by airy plumes in summer that fade to creamy white in fall. The seed heads provide food for birds and remain attractive throughout the winter.

- Mature height 3-4"
Mature spread 2-3"
- Full sun to part shade
- Low water needs
- Blooms late summer
- Attracts birds
- Resists deer, rabbits

CARE: It will adapt to any soil from sand to clay, and its tight clump can remain in place for years. It prefers evenly moist soil throughout the growing season; do not allow soil to completely dry out.

LAVENDER COTTON - *Santolina chamaecyparissus*

QTY. 3



A woody shrub that forms dense mounds of small, woolly leaves with bright yellow button-like flowers. Its evergreen foliage is incredibly fragrant.

- Mature height 12-18"
Mature spread 12-18"
- Full sun to part shade
- Low water needs
- Blooms midsummer
- Resists deer, rabbits

CARE: A long-lived evergreen shrub, this perennial requires little to no irrigation once established. Seldom needs dividing.

PLUMBAGO - *Ceratostigma plumbaginoides*

QTY. 3



This hardy perennial's striking blue flowers intermingle with shiny, green, ovate leaves that form an attractive spreading mound. In late autumn leaves turn burgundy red.



Mature height 8-12"
Mature spread 18-24"



Full sun to part shade



Low water needs



Blooms midsummer to fall



Attracts butterflies



Resists deer



CARE: During the winter, it will go dormant and it is late to emerge in spring so be sure to mark its spot in the garden to avoid accidental damage to the plant. Does not tolerate poorly drained soils.

RED CORAL BELLS - *Heuchera sanguinea* 'Splendens'

QTY. 6



The rich green, rounded leaves of Red Coral Bells create a thick mound sporting thin stalks with loose spikes of small, scarlet-red, bell-like flowers.



Mature height 12-18"
Mature spread 12-18"



Full sun to part shade



Medium water needs



Blooms late spring to early summer



Attracts hummingbirds



Resists deer, rabbits



CARE: This relatively low-maintenance plant appreciates well-drained soil and light shade. Appreciates a layer of winter mulch.

RED LEAF BERGENIA - *Bergenia crassifolia* 'Winterglut'

QTY. 5



Showy pink blossoms are carried on a leafless stalk, and the foliage color deepens to an incomparable red in fall and remains through the winter.



Mature height 12-15"
Mature spread 12-15"



Full sun to part shade



Medium water needs



Blooms early spring



Attracts butterflies



Resists deer, rabbits



CARE: Be sure to plant transplants and divisions deep enough to support the large rosettes. Will tolerate many average soil types. Dislikes heavy soils and standing water.

ROCK SOAPWORT - *Saponaria ocymoides*

QTY. 2

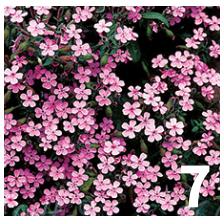

This vigorous ground cover provides you with dainty but prolific pink blooms for months, beginning in the spring.



Mature height 6-12"
Mature spread 12-18"



Full sun to part shade



Low water needs



Blooms late spring to early summer



Attracts butterflies, hummingbirds



Resists deer



CARE: This semi-evergreen plant appreciates regular watering to establish, then requires little water after the first year. Division or transplant not recommended due to long taproot.

SEA KALE - *Crambe maritima*

QTY. 1



A large perennial with bold, blue-green foliage that is lobed and sharply toothed, it boasts huge panicles of small white flowers that are showy and sweetly scented.



Mature height 4-6'
Mature spread 2-4'



Full sun to part shade



Medium water needs



Blooms summer



Attracts butterflies, hummingbirds



Resists deer



CARE: We recommend trying not to divide or move this plant as it has a very deep and thick taproot system that is difficult to move once established. This is a very long lived perennial, but be sure to leave it alone for first two years.

Plant Maintenance by Season

MAINTENANCE TASKS

PLANT

SPRING (AFTER FIRST GROWING SEASON)

Divide mature plants in early spring every 3 years, as needed.

Biokovo Cranesbill Geranium, Korean Feather Reed Grass, Plumbago, Red Leaf Bergenia

Cut back old growth or winter damage before new growth begins to emerge.

Korean Feather Reed Grass, Plumbago, Rock Soapwort

SUMMER

Deadhead spent flowers to encourage new blooms and/or minimize self-seeding.

Biokovo Cranesbill Geranium, Lavender Cotton, Red Coral Bells

After flowering, foliage may become tattered and worn. Remove the worst leaves.

Sea Kale

FALL

Tends to fall open with age. Prune hard after flowering to keep bushy and full.

Lavender Cotton

Do not cut back! Wait until spring to avoid winter damage.

Plumbago, Rock Soapwort

Cut back to 6 inches in the late fall to refresh foliage.

Red Coral Bells

WINTER

Shear lightly in mid-winter to tidy foliage, if desired.

Biokovo Cranesbill Geranium

Cut down to the ground for winter cleanup. Appreciates winter mulch.

Sea Kale

Plant-by-Number Design Suggestions

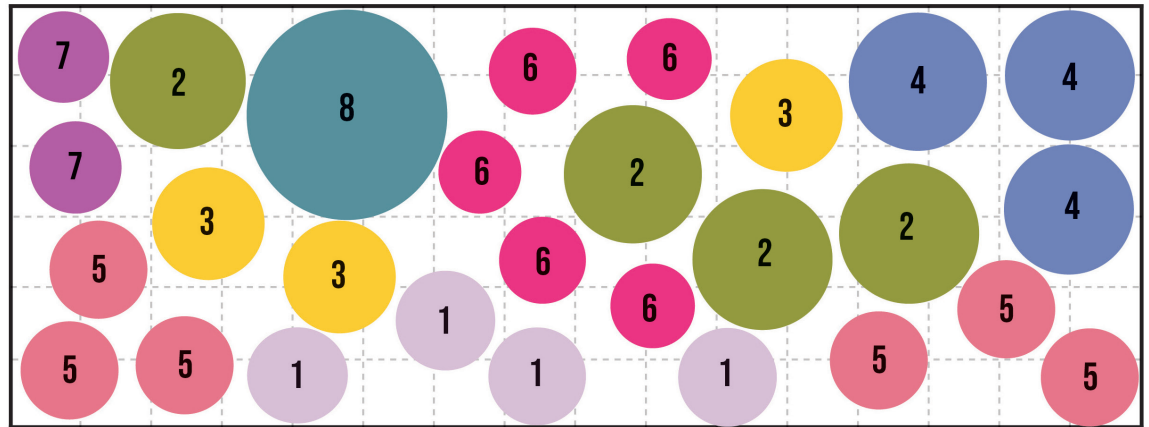

6' x 16' rectangle
SUGGESTED FRONT SIDE OF GARDEN

Key

1. Biokovo Cranesbill Geranium (Qty. 4)
2. Korean Feather Reed Grass (Qty. 4)
3. Lavender Cotton (Qty. 3)
4. Plumbago (Qty. 3)
5. Red Coral Bells (Qty. 6)
6. Red Leaf Bergenia (Qty. 5)
7. Rock Soapwort (Qty. 2)
8. Sea Kale (Qty. 1)

1 box = 1 square foot

Maps reflect bloom or showy foliage color.

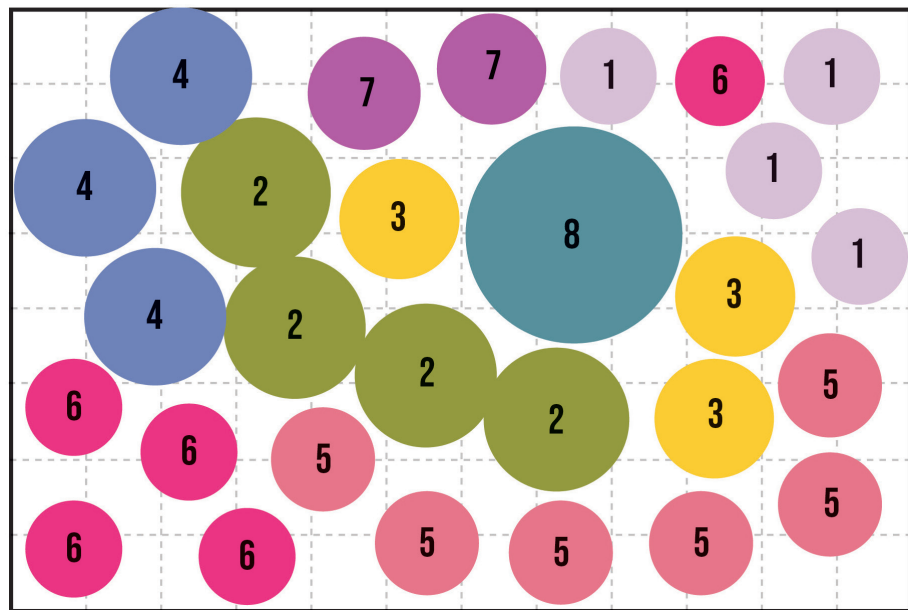

8' x 12' rectangle
SUGGESTED FRONT SIDE OF GARDEN

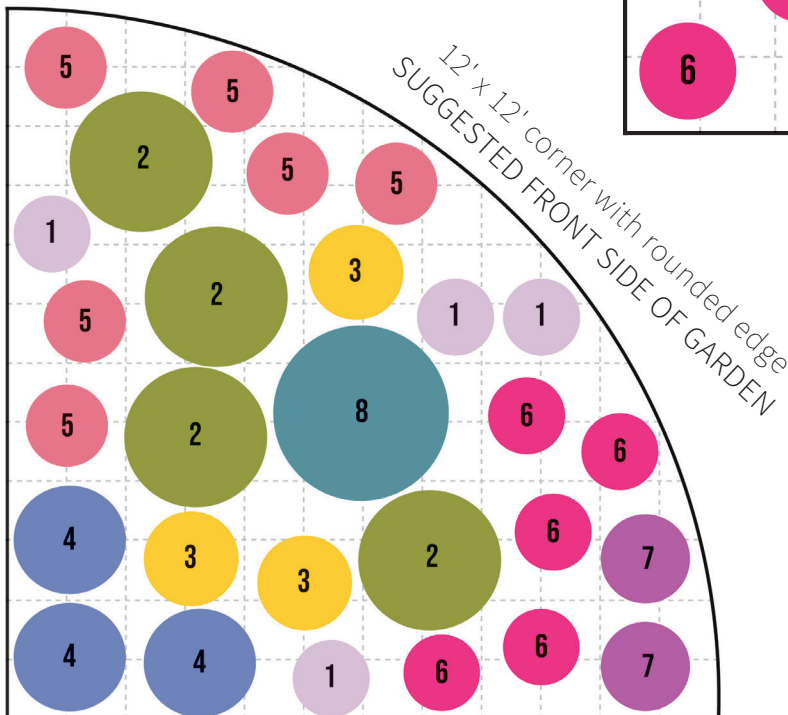

12' x 12' corner with rounded edge
SUGGESTED FRONT SIDE OF GARDEN