

Mountain Moonlight

Designed by Lina Dzekorius of Urban Oasis Design

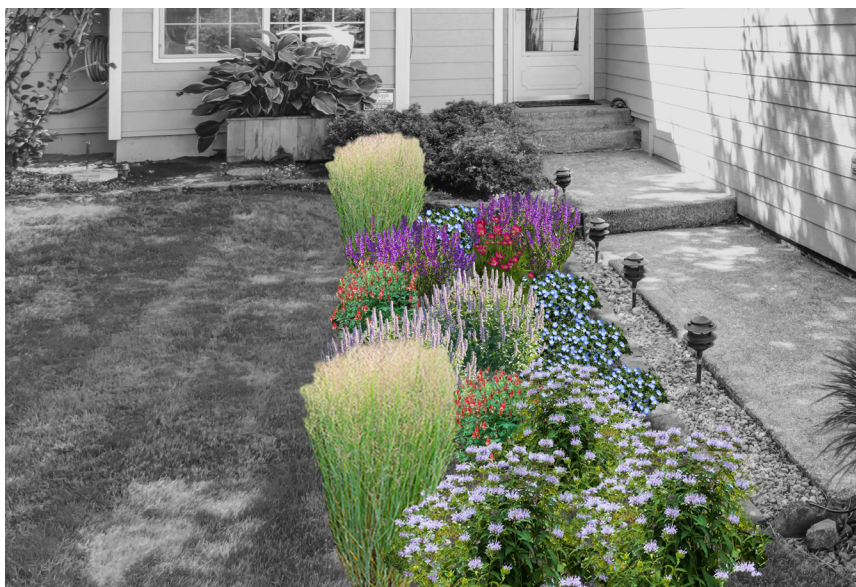

Add a beautiful glow to the sun dappled area of your yard with the Mountain Moonlight garden. This 60 square foot collection of plants pulls from the magenta, purple, and blue palette inspired by the glow of moonlight and is sure to delight the local pollinators.



Part shade exposure
(requires only 4 hrs of direct or indirect sun per day)



Planting map covers 60 sq. ft.



Blooms spring to fall



Low to medium water needs



Hardiness maximum of 7,500 ft.

Individual Plant Information

N indicates a regionally native plant

ANISE HYSSOP - *Agastache foeniculum* **N**

QTY. 2



This native variety of hyssop boasts spikes of lavender blue flowers atop triangular, dark green leaves on stout, square stems.



Mature height 2-4'
Mature spread 1-2'



Adaptable



Low water needs



Blooms summer to fall



Attracts bees, butterflies



Resists deer, rabbits



CARE: Water regularly for the first season to establish the root system. Make sure the soil is well drained, as Hyssop does not tolerate soil that is constantly wet. After it is established, it is very drought tolerant. Anise Hyssops prefer more shade than other, more southern varieties do.

CRYSTAL RIVER SPEEDWELL - *Veronica* 'Crystal River'

QTY. 3



Masses of tiny, blue flowers bloom in spring almost completely covering the plant, and later recur lightly sprinkled amongst the foliage throughout the summer.



Mature height 2-3"
Mature spread 20-30"



Adaptable



Low water needs



Blooms spring



Attracts butterflies



Resists deer



CARE: This plant is low maintenance and grows best in full sun to partial shade.

MCKANA'S IMPROVED COLUMBINE - *Aquilegia* 'McKana Hybrids'

QTY. 2



Large, bicolor flowers with long spurs in shades of pink, red, blue, yellow, and white hover above a loose clump of bluish-green foliage.



Mature height 24-30"
Mature spread 12-18"



Adaptable



Medium water needs



Blooms late spring to summer



Attracts bees, birds, butterflies



Resists deer, rabbits



CARE: Avoid heavy, soggy soil but provide regularly moist soil. Division is not recommended. Considered a short-lived perennial but will self-seed readily. Goes dormant mid-summer, so you may want to mark its spot with a stake so that you don't accidentally dig it up or weed it out.

NATIVE LAVENDER BEE BALM - *Monarda fistulosa menthifolia* N

QTY. 3



A flowering member of the mint family, its signature fountain-shaped blooms and aromatic foliage are reminiscent of mint and orange, making it hard to forget.



Mature height 2-3'
Mature spread 18-24"



Full sun



Low water needs



Blooms
midsummer



Attracts bees,
butterflies,
hummingbirds



Resists deer,
rabbits



CARE: In general, this hardy perennial thrives best in moist to slightly dry soils in sunny, dry locations.

ROCKY MOUNTAIN PENSTEMON - *Penstemon strictus* N

QTY. 2



The brilliant, midnight blue flowers form on stout stalks arising from narrow, glossy, green leaves. This semi-evergreen variety is native to the Rockies.



Mature height 18-24"
Mature spread 12-18"



Full sun to part shade



Low water needs



Blooms early to
midsummer



Attracts native
bees



CARE: Penstemon varieties prefer not to be overcrowded and prefer maximum heat and sun exposure. Avoid enriching the soil around these finicky plants - it will shorten their lifespan. This semi-evergreen can be slow to establish, so be sure to weed around it regularly to improve establishment.

SWITCHGRASS - *Panicum virgatum* N

QTY. 2



Switchgrass forms dense, elegantly tall strands of green, changing to deep red throughout the summer and ending the season as a burgundy wine color in the fall.



Mature height 3-5'
Mature spread 18-24"



Full sun to part shade



Low water needs



Blooms late
summer



Attracts butterflies,
small birds



CARE: Extremely drought tolerant and grows well in any type of soil. Grass can spread by rhizomes if given the space, so division is recommended to control growth habit.

WINDFLOWER - *Anemone multifida* N

QTY. 1



Deeply cut dark green leaves form a rounded clump with wiry stems rising to reddish-purple flowers with bright yellow stamens.



Mature height 1-2'
Mature spread 12-18"



Part shade



Medium water needs



Blooms early
summer



Attracts bees,
butterflies



Resists deer,
rabbits



CARE: This relatively low-maintenance, native windflower variety appreciates well drained soil and light shade.

Plant Maintenance by Season

MAINTENANCE TASKS	PLANT
SPRING (AFTER FIRST GROWING SEASON)	
Divide mature plants in early spring every 3-4 years, as desired.	Crystal River Speedwell, Rocky Mountain Penstemon, Windflower
Cut back old growth or winter damage in mid to late spring.	Anise Hyssop, McKana's Improved Columbine, Rocky Mountain Penstemon, Windflower
"Comb out" or remove dead foliage in mid to late spring.	Crystal River Speedwell
SUMMER	
Deadhead spent flowers to encourage new blooms and compact growth and/or minimize self-seeding.	McKana's Improved Columbine, Native Lavender Bee Balm, Rocky Mountain Penstemon
FALL	
Leave last round of blooms to self-seed and/or to provide food for birds.	McKana's Improved Columbine, Rocky Mountain Penstemon
Do not prune or cut back! Wait until spring to cut back to avoid crown rot.	Anise Hyssop, McKana's Improved Columbine

Plant-by-Number Design Suggestion

Key

1. Anise Hyssop (Qty. 2)

2. Crystal River Speedwell (Qty. 3)

3. McKana’s Improved Columbine (Qty. 2)

4. Native Lavender Bee Balm (Qty. 3)
5. Rocky Mountain Penstemon (Qty. 2)

6. Switchgrass (Qty. 2)

7. Windflower (Qty. 1)

1 box = 1 square foot Map reflects bloom or showy foliage colors.

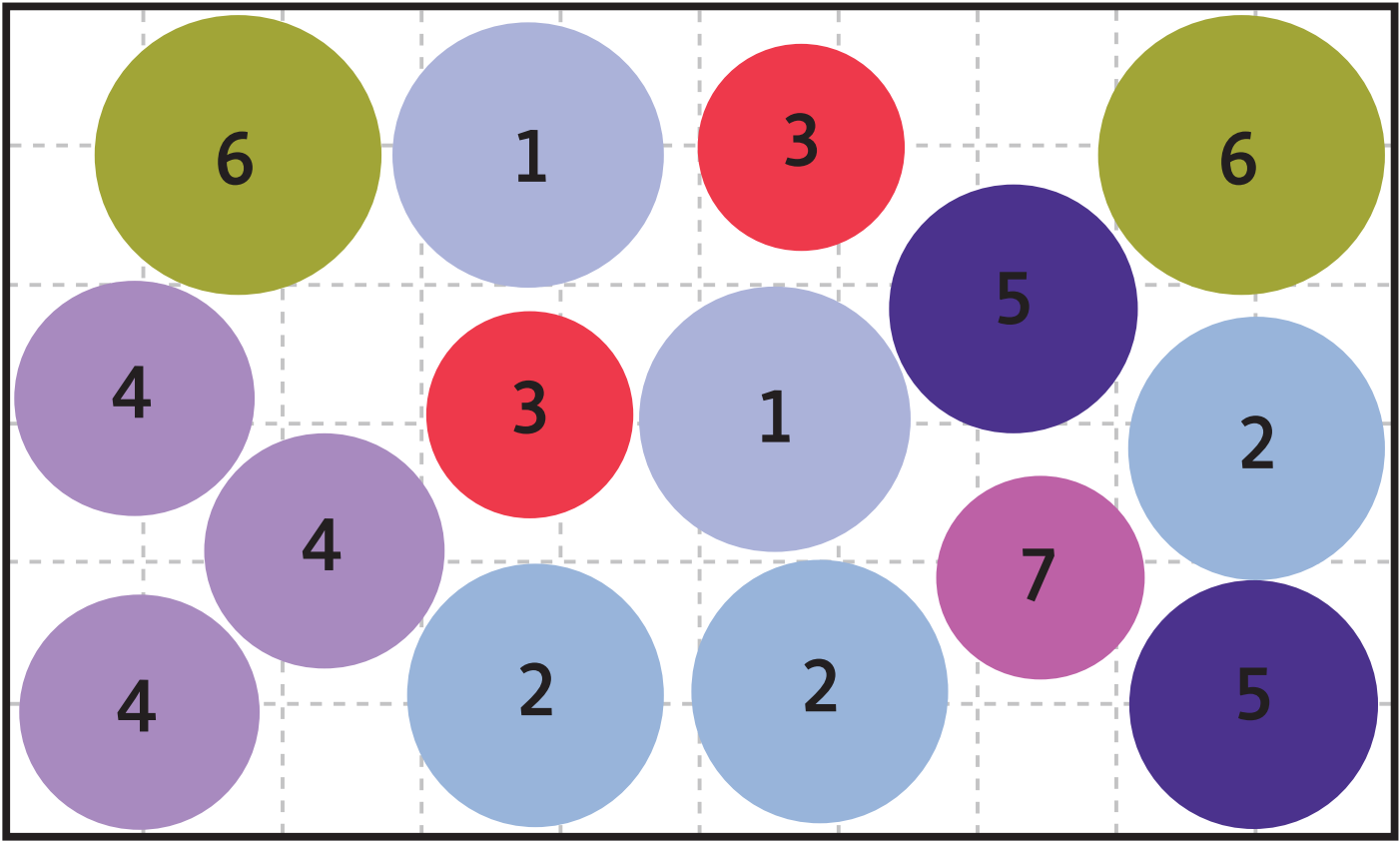

6'x10' rectangle
SUGGESTED FRONT SIDE OF GARDEN