

Native Plant Adaptable Combo

Key

Mountain Blooms

- M 1. Anise Hyssop (Qty. 3)
- M 2. Black-Eyed Susan (Qty. 2)
- M 3. Blue Harebell (Qty. 5)
- M 4. Cutleaf Coneflower (Qty. 2)
- M 5. Native Lavender Bee Balm (Qty. 3)

- M 6. Pearly Everlasting (Qty. 2)
- M 7. Rocky Mountain Columbine (Qty. 5)
- M 8. Smooth Aster (Qty. 3)
- M 9. Smooth Aster (Qty. 3)

Pollinator Peak

- P 10. Bigelow's Tansyaster (Qty. 2)
- P 11. Blaze Little Bluestem Grass (Qty. 3)
- P 12. Native Lavender Bee Balm (Qty. 2)
- P 13. Rocky Mountain Penstemon (Qty. 2)
- P 14. Sulphur Flower (Qty. 3)
- P 15. White Yarrow (Qty. 1)
- P 16. Windflower (Qty. 2)

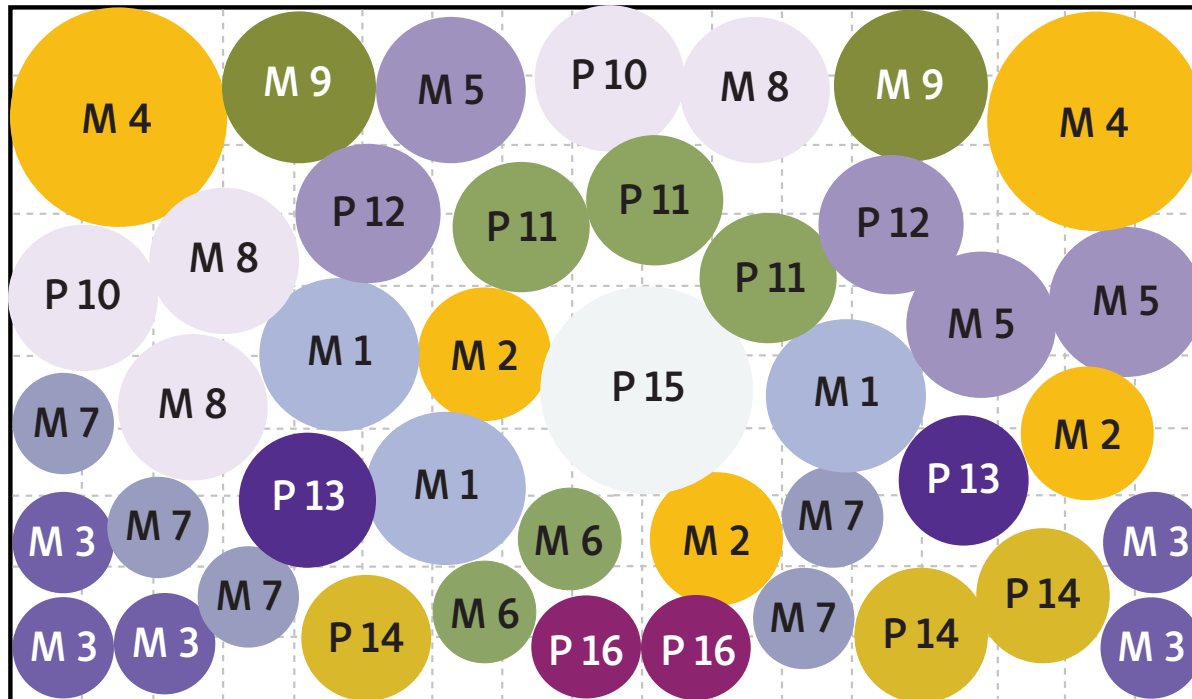

10'x17' rectangle
SUGGESTED FRONT SIDE OF GARDEN

Map reflects bloom or showy foliage colors.
1 box = 1 square foot

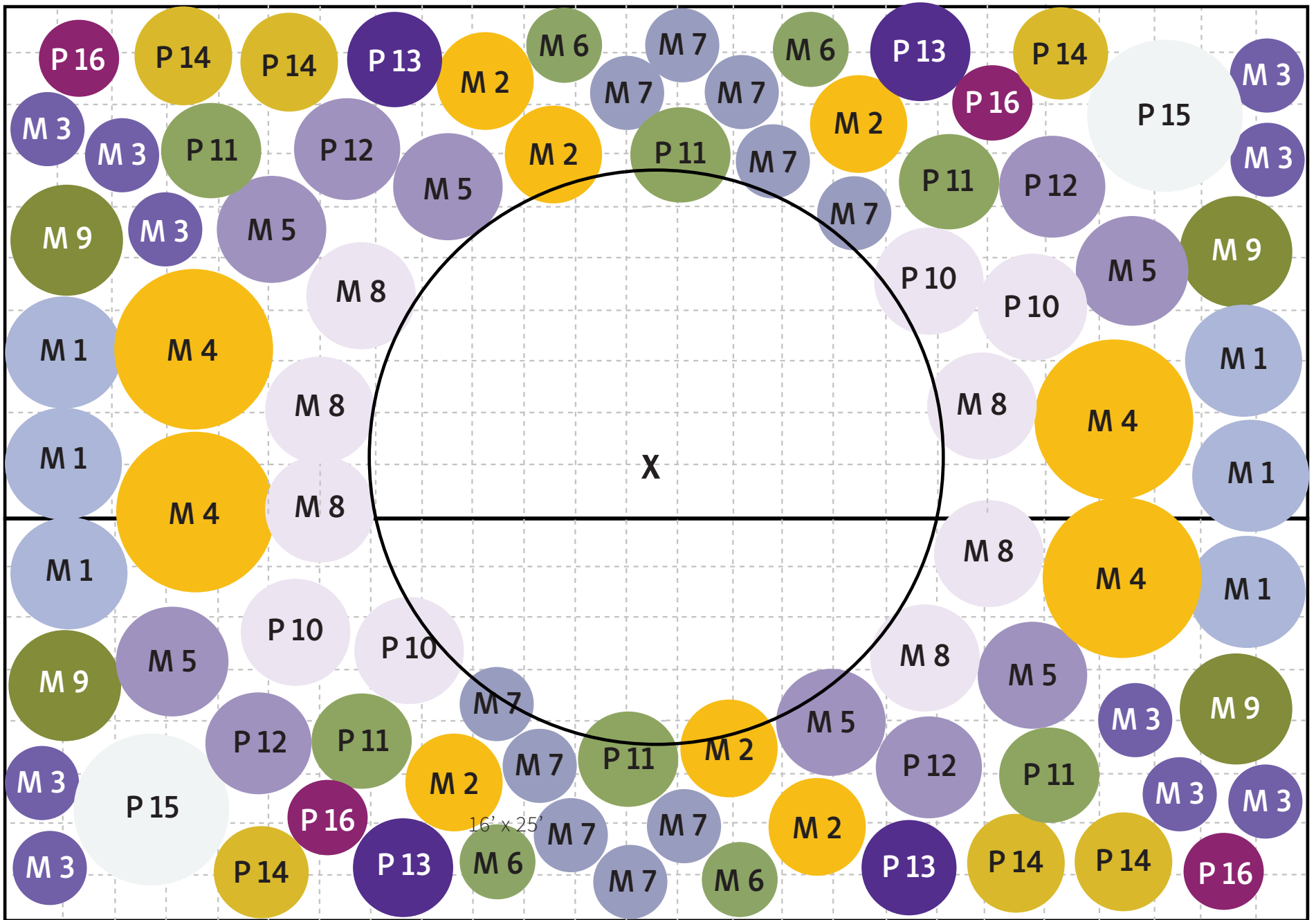

Note: This planting map combines two Mountain Blooms and two Pollinator Peak gardens into a 400 square foot garden with space for an existing or new tree. Follow one half of this map (the top or bottom portion) if one of each was purchased.