



# Biodiversity Nursery

Designed by Lauren Freels, City of Boulder Climate Initiatives Office



## Garden Summary



Full sun exposure



Plant by Number maps cover 100 sq. ft.



Very low to low water needs



Hardy to 7,000 ft. in altitude

## Plant Icon Key



Supports pollinators



Resistant to deer



Regionally native plant



Resistant to rabbits

## Individual Plant Information

### 1. BEARD-LIP PENSTEMON - *Penstemon barbatus*

**QTY. 5**



Mature height 2-3'  
Mature spread 12-18"



Blooms summer

**ADDITIONAL INFO:** An extremely low maintenance plant. Grows best in dry to medium well-drained soils in full sun, but can tolerate even dry and rocky soils. Prune spent blooms to improve the plant's appearance.

### 2. BLACK-EYED SUSAN - *Rudbeckia hirta*

**QTY. 2**

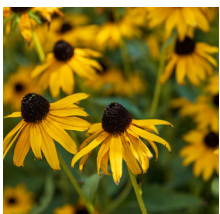

Mature height 18-24"  
Mature spread 18-24"



Blooms summer to fall

**ADDITIONAL INFO:** Easily grown in well-drained soils when planted in full sun. It is considered a short-lived perennial that typically survives 4-6 years, but it will spread by seed. Appreciates a little extra moisture in well drained soils but still a drought tolerant plant.

### 3. BLUE FLAX - *Linum lewisii*

**QTY. 5**



Mature height 1-2'  
Mature spread 12-18"



Blooms late spring to summer

**ADDITIONAL INFO:** Thrives in open areas along ridges and dry slopes, making it an ideal candidate for dry, open, sunny locations. It performs best in well-draining soils. Mulch with gravel or not at all. Since this plant has an extensive tap root, it does not like to be transplanted or divided once established.

4. EVENING PRIMROSE - *Oenothera macrocarpa*

QTY. 6



Mature height 1-2'  
Mature spread 18-24"



Blooms late spring  
to summer

**ADDITIONAL INFO:** Fares well in hot, dry areas with well-drained soil, and once established, it will become drought-tolerant. Prevent complete soil dryness, and maintain a mulch layer.

5. GIANT SACATON GRASS - *Sporobolus wrightii*

QTY. 3



Mature height 3-6'  
Mature spread 2-3'



Blooms  
summer

**ADDITIONAL INFO:** A very drought-tolerant plant that, once established, does best with little to no supplemental watering.

6. PRAIRIE SAGE - *Artemisia ludoviciana*

QTY. 2



Mature height 1-4'  
Mature spread 2-3'



Blooms  
midsummer

**ADDITIONAL INFO:** Performs best in dry, well-drained soils. Plant becomes leggy and vulnerable to root rot in moist soils. Plant spreads easily through self-seeding. If this is undesired, promptly remove spent flower heads.

7. RIGID GOLDENROD - *Solidago rigida*

QTY. 2



Mature height 1-3'  
Mature spread 18-24"



Blooms summer

**ADDITIONAL INFO:** This important species for native pollinators is very hardy and adaptable to various growing conditions. Tolerant of a variety of soil types, Goldenrod can self-seed easily. If this is undesired, deadhead blooms before they turn to seed.

8. SMOOTH ASTER - *Symphyotrichum laevis* var. *geyeri*

QTY. 4



Mature height 2-4'  
Mature spread 18-24"



Blooms summer  
to fall

**ADDITIONAL INFO:** Tolerant of a variety of soil types, this is a very low maintenance plant. It self-propagates by non-aggressive rhizomatous roots. If this is undesired, division is recommended.

# Plant Maintenance by Season

## MAINTENANCE TASKS

## PLANT

### SPRING (After first growing season)

Divide mature plants in early spring every 3-4 years, as desired.

Prairie Sage, Smooth Aster

Cut back old growth or winter damage in mid to late spring.

Beard-lip Penstemon, Black-eyed Susan, Blue Flax, Evening Primrose, Giant Sacaton Grass, Rigid Goldenrod, Smooth Aster

### SUMMER

Deadhead spent flowers to encourage new blooms and compact growth, or to minimize self-seeding.

Beard-lip Penstemon, Black-eyed Susan, Evening Primrose, Prairie Sage, Rigid Goldenrod, Smooth Aster

Water sparingly once established.

Giant Sacaton Grass

### FALL

Leave last round of blooms to self-seed and/or provide food for birds.

Beard-lip Penstemon, Black-eyed Susan, Blue Flax, Evening Primrose, Rigid Goldenrod

Do not prune or cutback. Plant susceptible to winter damage if pruned.

Smooth Aster

## Plant by Number Design Suggestions

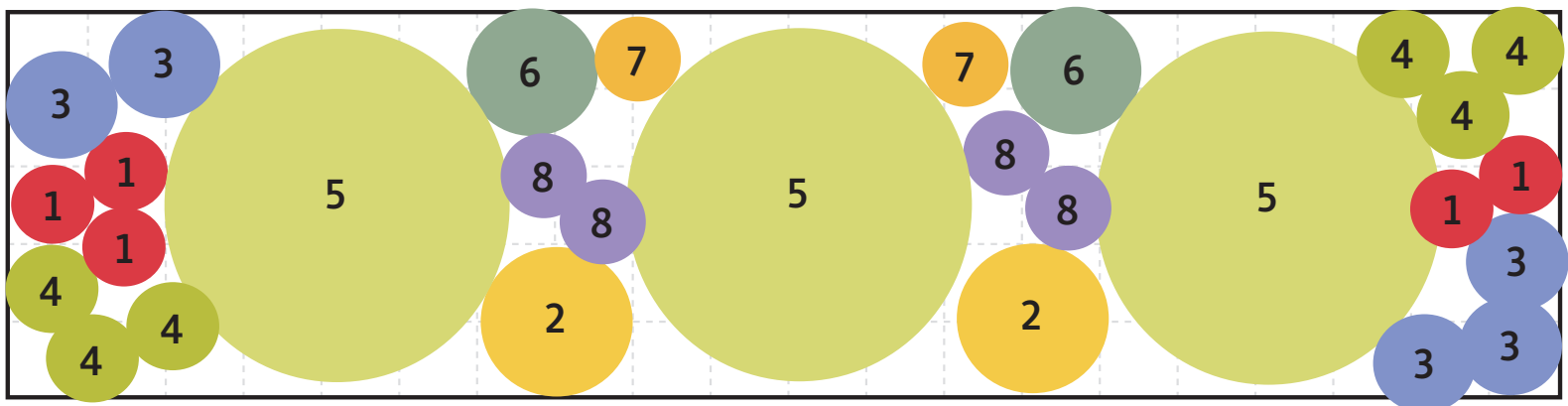

20' x 5' rectangle  
SUGGESTED FRONT SIDE OF GARDEN

# Plant by Number Design Suggestions

## Key

- |                                 |                                 |
|---------------------------------|---------------------------------|
| 1. Beard-lip Penstemon (Qty. 5) | 5. Giant Sacaton Grass (Qty. 3) |
| 2. Black-eyed Susan (Qty. 2)    | 6. Prairie Sage (Qty. 2)        |
| 3. Blue Flax (Qty. 5)           | 7. Rigid Goldenrod (Qty. 2)     |
| 4. Evening Primrose (Qty. 6)    | 8. Smooth Aster (Qty. 4)        |

1 box = 1 square foot  
Map reflects bloom or showy foliage colors.

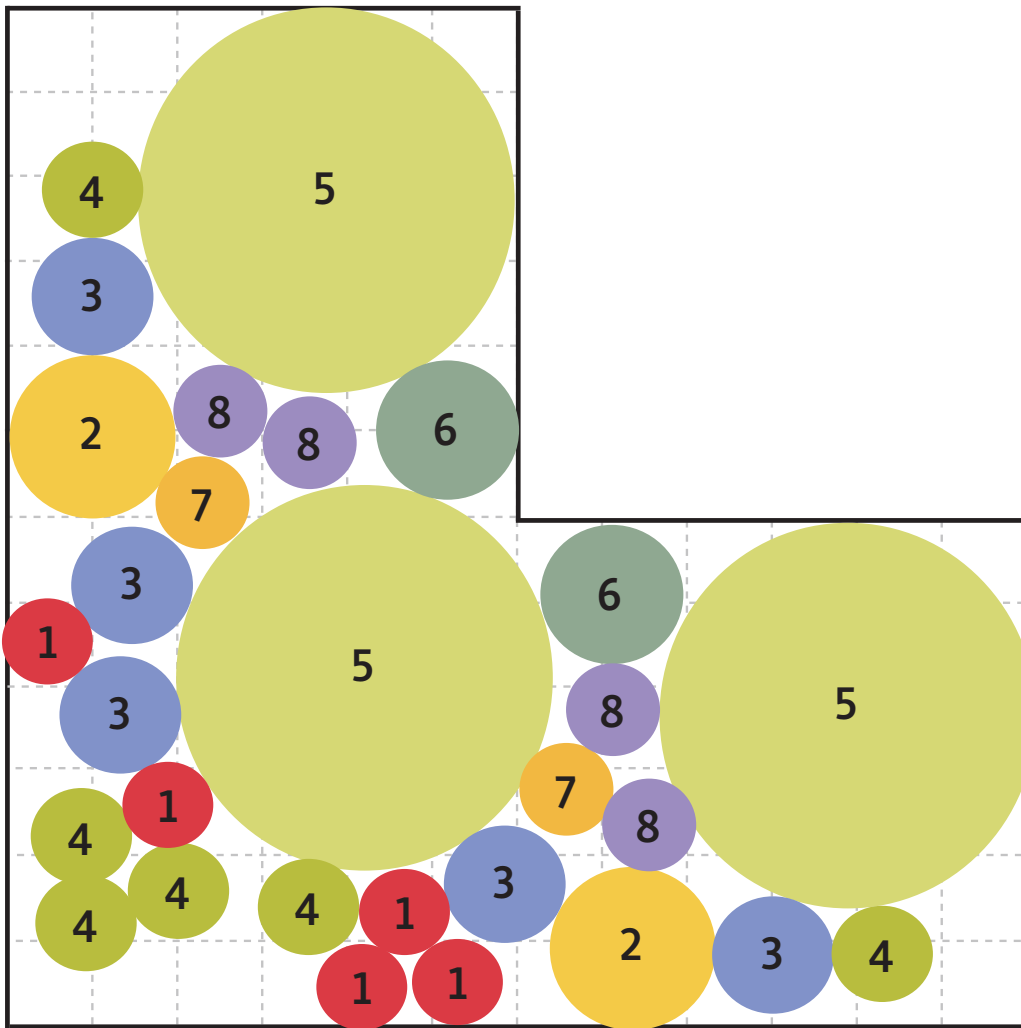

12' x 12' corner  
SUGGESTED FRONT SIDE OF GARDEN